

CONCRETE APRON AT DRIVEWAY  
ENTRANCE DETAIL  
NO SCALE

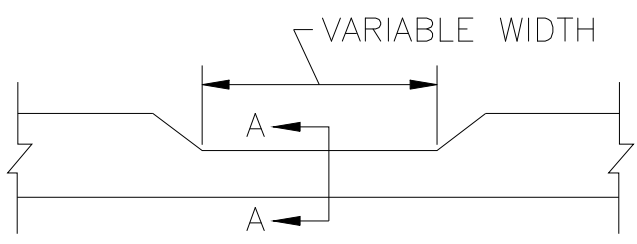

PLAN VIEW

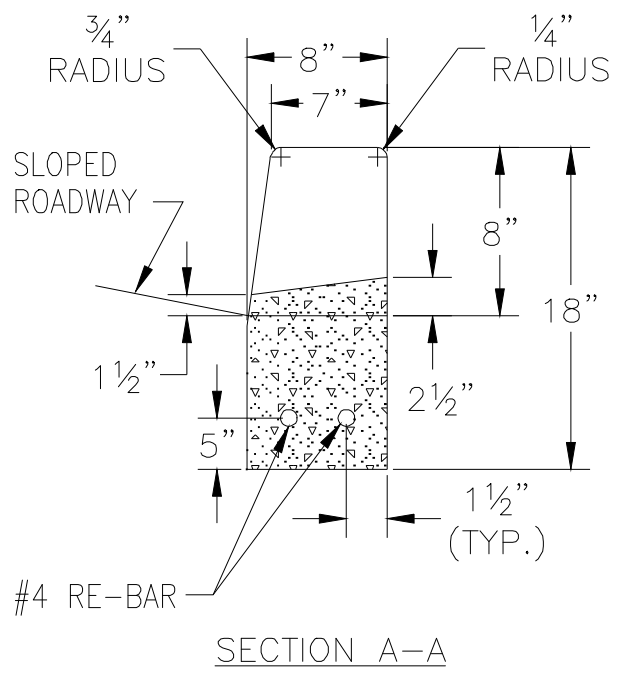

SECTION A-A

DRIVEWAY ENTRANCES:

(A) DRIVEWAY ENTRANCES OR APRONS WITHIN THE STREET RIGHT-OF-WAY SHALL BE SURFACED TO THEIR FULL WIDTH. THE WIDTH OF ACCESS ROADS OR DRIVEWAYS SHALL BE IN ACCORDANCE WITH THE FOLLOWING STANDARDS.

- (1) FOR MULTI-FAMILY RESIDENTIAL, MOBILE HOME PARKS, AND ALL NON-RESIDENTIAL DEVELOPMENTS OR SUBDIVISIONS, DRIVEWAY ENTRANCES SHALL BE NO LESS THAN TWENTY FOUR (24) FEET IN WIDTH AT THE STREET LINE, AND SHALL CLEARLY BE DEFINED BY THE USE OF CURBING.
- (2) FOR SINGLE FAMILY RESIDENTIAL, DRIVEWAYS SHALL BE NO LESS THAN TEN (10) FEET IN WIDTH AND NO GREATER THAN TWENTY (20) FEET IN WIDTH AT THE STREET LINE.



THE CITY OF HARRISBURG  
OFFICE OF THE CITY ENGINEER

PROJECT: STANDARD DRIVEWAY DETAIL	
DRAWN BY: MICHAEL J. HILTON	DATE: SEPTEMBER 25, 1996
CHECKED BY: KRISTIE A. HEBERLIG	SCALE: NONE

SHEET:  
D-4